

## REAR OF BUILDING

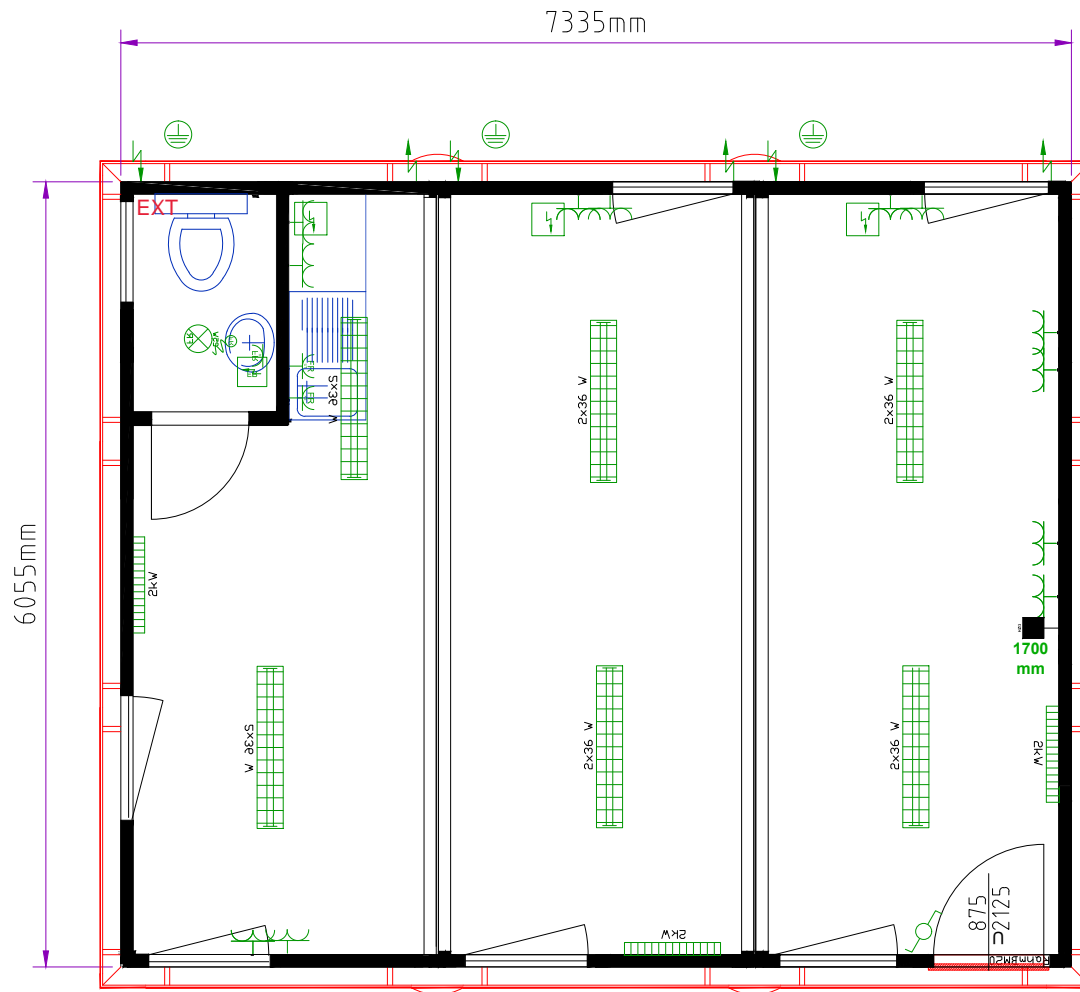

## FRONT OF BUILDING

### 3 SECTION WELFARE MODULAR BUILDING

7.3m x 6m (44m<sup>2</sup>) / 24' x 20' (480ft<sup>2</sup>)

#### This building consists of...

1 or 2 External Doors with glazed vision panel (875mm x 2000mm)

Up to 7No. UPVC Double Glazed Tilt & Turn Windows with integrated Aluminum Roller Shutters / Blinds

Twin Power Sockets throughout

2kW Eco Heaters with Integrated Timer

Cat2 Light Fittings

Grey Vinyl over 22mm High Density Cement Bound Flooring

Stainless-Steel Sink, Work-Surface, Water-Heater & Base Unit

Full Toilet Suite

**Window & door layout can be configured to meet your requirements**

Est. 1999  
**concept**<sup>o</sup>  
accommodation ltd

info@conceptaccommodation.co.uk

www.conceptcabins.co.uk